



Clou inside

NIESMANN
+BISCHOFF

Rettenungskarte

Arto 84/88

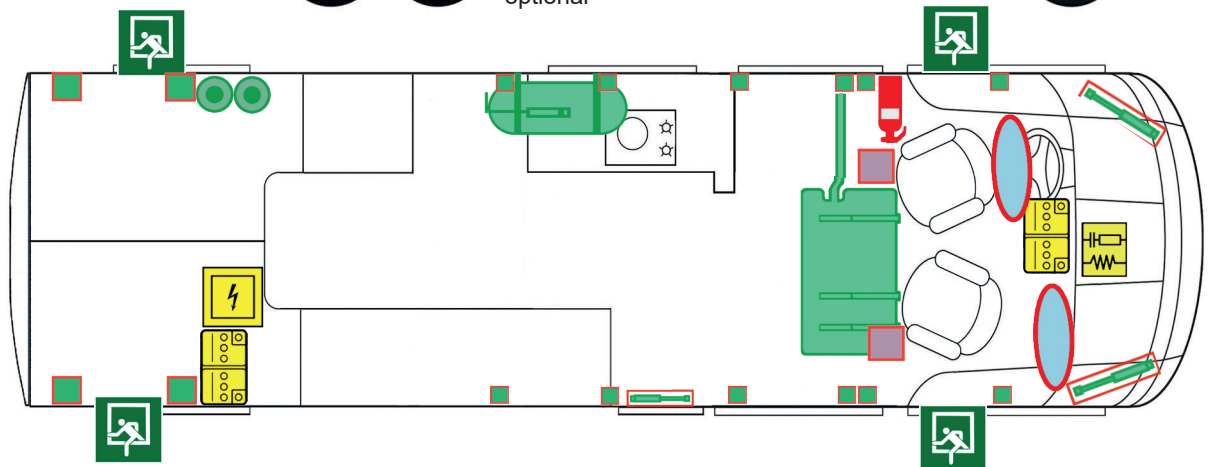
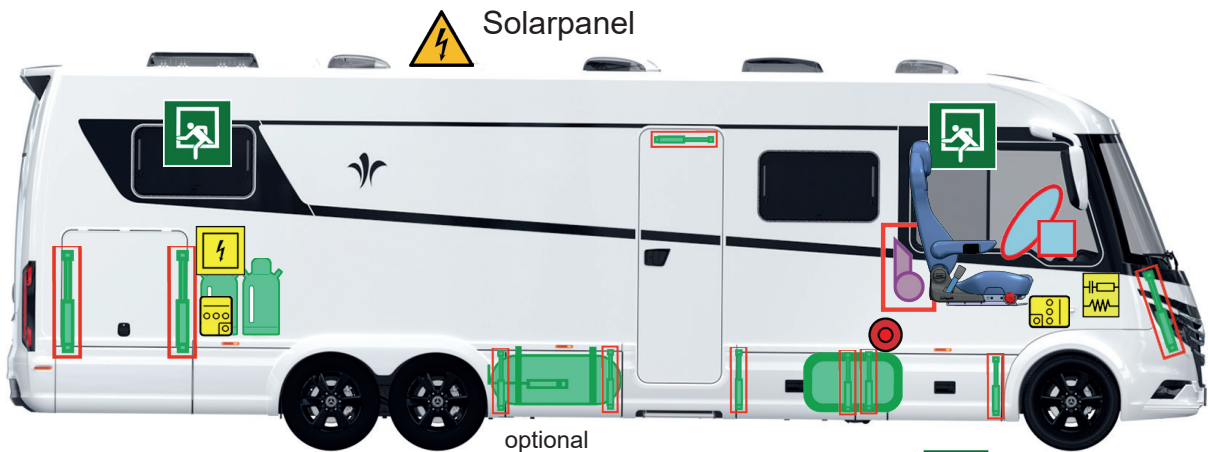

| | | | | | |
|--|--------------|--|---------------------|--|----------------|
| | Airbag | | Gasdruckdämpfer | | 12V- Batterie |
| | Gurtstraffer | | Kraftstofftank | | Elektroeinheit |
| | Steuergerät | | Gasflasche | | Feuerlöscher |
| | | | Gas tank (optional) | | FRA, NOR |

Rettenungskarte gut sichtbar im Handschuhfach auf der Beifahrerseite aufbewahren!



Clou inside

NIESMANN
+BISCHOFF

Rescue card

Arto 84/88

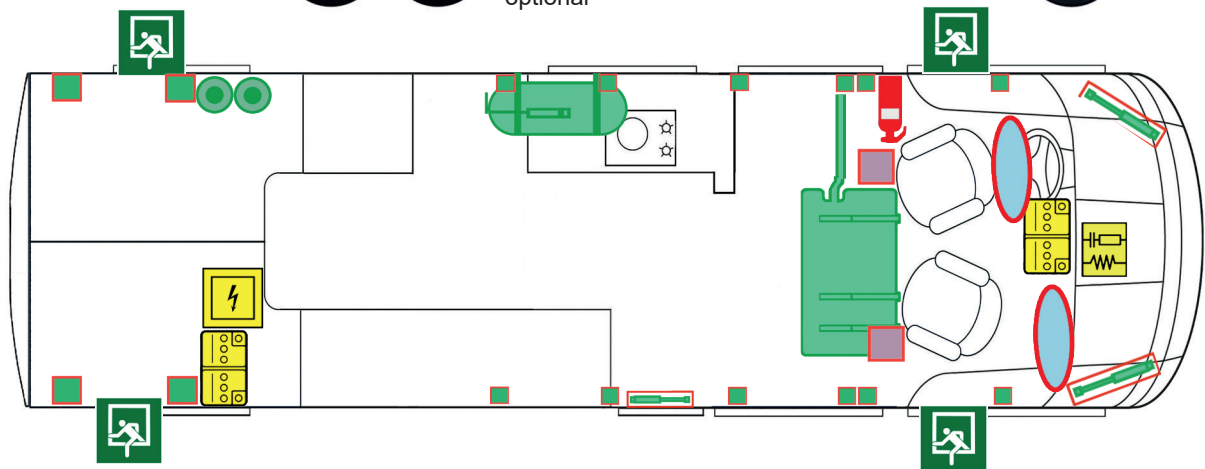
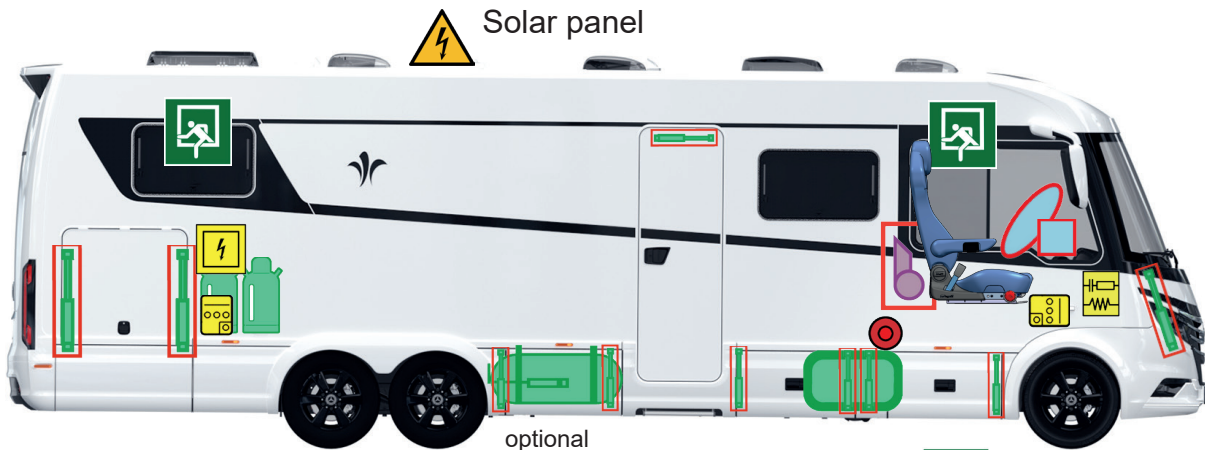

| | | | | | |
|--|---------------------|--|-----------------------|--|-------------------|
| | Air bag | | Gas pressure dampener | | 12V- Battery |
| | Seat belt tensioner | | Fuel tank | | Electric system |
| | Control unit | | Gas bottle | | Fire extinguisher |
| | | | Gas tank (optional) | | FRA, NOR |

Keep rescue card well visible in the glove box on passenger side!